

Mimitakara[®]



@goodHearing P2

User Guide

WELCOME	P 1
YOUR HEARING AID.....	P 2
ACCESSORIES.....	P 4
FEATURES	P 5
WEARING INSTRUCTION & SET UP.....	P 6
POWER ON/OFF	P 8
CHARGING INSTRUCTION	P 9
VOLUME CONTROL	P 11
MODE SWITCH	P 12
NOISE CONTROL.....	P 13
BLUETOOTH SETTING	P 14
USER SUPPORT	P 18
WARRANTY.....	P 20
TROUBLESHOOTING.....	P 21
FAMILIAR WITH HEARING AID.....	P 24
SPECIFICATION.....	P 26

WELCOME

Mimitakara welcomes you to join and to be a part of our global family. This is a fabulous decision for choosing Mimitakara Hearing Aids to accompany you in day-to-day life. If this is your first experience with Mimitakara products, believe us it's gonna be awesome and merely takes a few minutes to get familiar.

This user guide will take you through all its operations and initial setup. For a better user experience, we recommend wearing it throughout the day.

Mimitakara Connecting Hearts

YOUR HEARING AID

You have purchased P2, a goodHearing series device that uses our patented Millisecond Shift Technology to restore hearing loss. To suit your requirement in various environmental situations. It uses sound processing with up to 8 channels combined with three different hearing modes, to suit your requirement in various environmental situations.

P2 provides you to switch between the Bluetooth mode to Hearing Aid mode effortlessly and vice versa. You can easily answer your phone, watch TV, listen to music, enjoy high-quality listening all just with the help of P2.

Mimitakara One Product Many Solutions

Note:

We strongly recommend seeking professional assistance first, understand hearing condition & eliminate pathological problems before wearing. Volume should be adjusted in moderation range, high volume may cause hearing damage.

Mimitakara@goodHearing P2 is not intended for children under 3 years of age.

1. ACCESSORIES

- 1 Main unit with built-in ear buds (M size)
- 2 2 x Additional pair of L/S/XS Size ear buds
- 3 Type-C Charging Cable



2. FEATURES

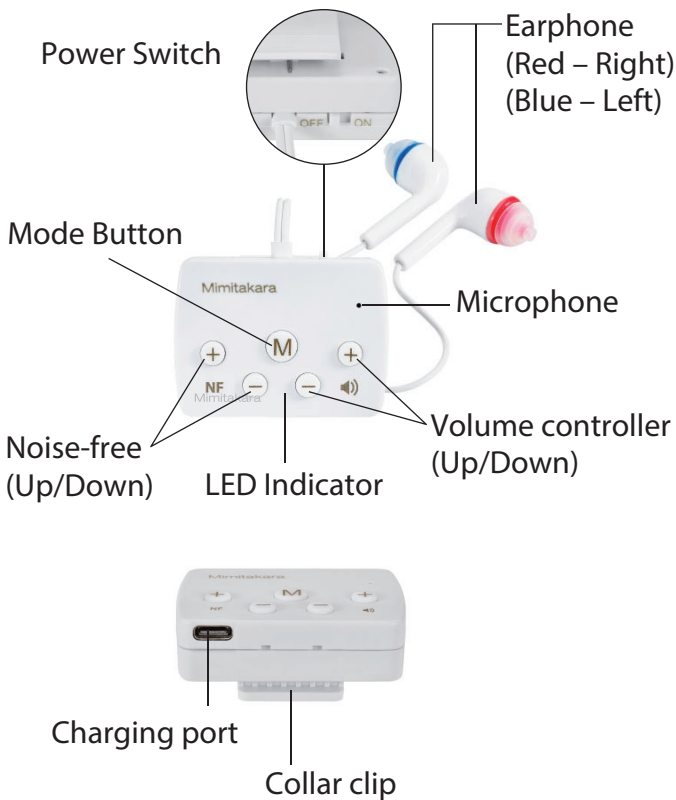

WEARING INSTRUCTION & SET UP

1. Securely fit the red earphone into the right ear and the blue earphone into the left ear. Insert both ears tightly into ear canal to prevent the feedback sound (whistling).



2. Turn the unit ON and adjust the volume settings to suit your needs. Turn the unit off when not in use.



3. We suggest clipping the device to the outside shirt pocket or collar to avoid it from rubbing against objects in order to reduce the static sounds (Ensure the microphone is not obstructed for optimum sound quality).



POWER ON / OFF

Power ON: Turn on by moving the power switch to right. When the unit is turned on the LED Indicator Light will flash blue.

※ It may not power ON if the battery is low, please recharge the unit before start using it.

Power OFF: Turn off by moving power switch to left, the indicator light will be off. Please charge it every day.

※ Please recharge the unit when battery power is too low.

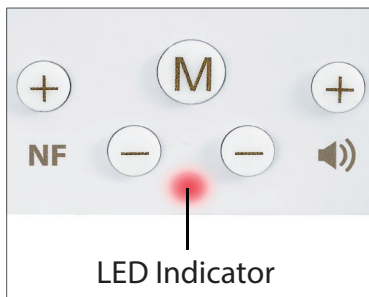

CHARGING INSTRUCTION

When charging indicator flashes red light, it means the battery power is low, please charge it immediately. It takes about 3 hours to charge and provides about 10 hours of continuous use of hearing aids when fully charged.

Plug the USB Type C Charging Cable into the Wireless Charging Case and the other end into the USB Adapter (the adaptor is not included).

- Charging: Solid Red LED Indicator
- Fully charged: Solid Blue LED Indicator

CAUTION

- ✘ Avoid charging in high temperature environment.
- ✘ When the indicator light flashes red, it means the battery is about to run out of power, so please charge it immediately. If you use it until

it is completely dead, it will damage the battery life.

- ※ It is recommended to replace the battery every two years, please contact your dealer for replacement.

VOLUME CONTROL

Please press the volume button to adjust the volume level according to the hearing loss level. When you press the volume button, you will hear a "beep" sound in the earphone to remind you of the volume adjustment change.

- Increase level: Press ⊕ to increase the volume
- Decrease level: Press the ⊖ key to decrease the volume
- Volume level instruction table

Volume Level	Gain (dB)	Hearing Loss (dB)
+5	55	120
+4	50	110
+3	45	100
+2	40	95
+1	35	80
Default Setting	30	70
-1	25	60
-2	20	55
-3	15	45
-4	10	35
-5	5	25

MODE SWITCH

Mode button short press: Mode Switch

There are 3 pre-set modes on the goodHearing P2. To switch between the 3 modes, click the button, a beep will be heard when switching between the 3 modes to indicate which mode it is currently set it.

Mode 1: Standard Mode(one beep) :

Mostly used indoor where the environment is not too noisy.

Mode 2: Noise Cancelling Mode (two beeps)

Used in louder environment such as outdoor public areas, restaurants.

Mode 3: High-level Noise Cancelling Mode (three beeps)

Providing superior noise cancelling in even the loudest environments, such as in transportation.

NOISE CONTROL

When you feel that there is a lot of noise in the surrounding environment, you can adjust your noise reduction button according to your needs.

Press the noise reduction button directly

- a. Increase Noise Reduction: Press the ⊕ key to increase noise reduction
- b. Decrease Noise Reduction: Press the ⊖ key to decrease noise reduction

PARING BLUETOOTH

Press and hold the Mode Switch to enter the Bluetooth paring mode, it can be paired with devices such as mobile phone, tablet, etc.

1. Press and hold the Mode Switch for **3 seconds**
The LED Indicator will flash alternating BLUE and RED colors
2. Turn on the Bluetooth function on your mobile device
3. Scan for nearby devices
4. Pair with goodHearing P2
5. When pairing has been successful your phone will show that the status is connected with goodHearing P2

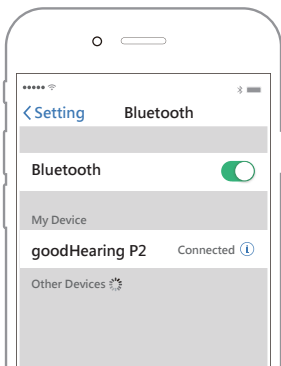

※ The above interface may vary depending on the operating system version.

CAUTION:

1. Turn on Bluetooth on your phone side (Host Bluetooth device).
2. Bluetooth hearing aids need to be paired with the same (Host Bluetooth device) only once. Paired devices will remember each other unless pairing information is deleted, so there is no need to pair again.

TIPS:

- This product has a rechargeable design and the battery can be used for approximately 2 years under normal operating conditions. To effectively extend the life of rechargeable batteries, when not in use for a long time, please charge the hearing aid battery before using.

- Do not allow infants or involuntary persons to use this product.
- This hearing aid is strictly prohibited from self-disassembly, modification, repair ... such acts, the above behavior does not fall within the scope of a warranty.
- Before use, clean the ear canal and use it to prevent ear canal secretions from clogging the horn hole and affecting the quality of the receiver.
- Depending on the characteristics of the rechargeable battery, the volume will be weaker than usual when the battery is low; For those with hearing loss problems, please seek the assistance of a professional physician, understand their hearing conditions to eliminate pathological problems, and then wear the hearing aid will be good.

- Use the appropriate volume, too high volume can damage/ affect the hearing.

USER SUPPORT



Maintenance

- Before each use: Clean the ear canal each time you use it
- After each use: After use, use a small brush to remove the earwax around the earbuds, be sure to keep the small holes in the earbuds open, to maintain long-term normal operation, earwax blockage may affect the effectiveness of hearing aids.

Please try to keep your hearing aid dry and clean. Humid, earwax, ear water and so on will affect the service life and performance of the hearing aid.

1. Use a cleaning brush or a soft cloth to clean the hearing aids, microphones, and dirt on the charging holes.
2. Never clean your hearing aid with water, solvents, cleaning fluids, or cleaning oil.
3. If the hearing aid is not in use for a long time, charge it regularly every week.
4. Avoid direct sunlight, Keep at a dry & safe place.
5. Avoid excessive high and low temperatures.
6. Avoid places that are accessible to infants and young children.

WARRANTY

1. Mimitakara provides a one-year warranty.
2. Under normal conditions use, provides free repair services. Earplugs, horns, horn lines, (Personal hygiene accessories are not covered by the warranty)
3. The product improperly handled/ miss-used/ damaged shall be charged at the discretion when they need to be repaired.
4. Serious damage product or self-disassembly or modification will not be repaired.
5. Damage caused by uncontrolled factors such as natural disasters and fires is not covered in the warranty.
6. If you need repair services, please send the product with the warranty form to the Company.

WARRANTY

1. Mimitakara provides a one-year warranty.
2. Under normal conditions use, provides free repair services. Earplugs, horns, horn lines, (Personal hygiene accessories are not covered by the warranty)
3. The product improperly handled/ miss-used/ damaged shall be charged at the discretion when they need to be repaired.
4. Serious damage product or self-disassembly or modification will not be repaired.
5. Damage caused by uncontrolled factors such as natural disasters and fires is not covered in the warranty.
6. If you need repair services, please send the product with the warranty form to the Company.

Troubleshooting

For any reason, do not service your hearing aid yourself, that can easily cause more damage to the hearing aid and you. Refer to troubleshooting when your hearing aid is unusable or unusual. If the troubleshooting doesn't solve your problem, please contact initial point of purchase or our customer service team at:

www.digisineproducts.com

www.mimitakarahealth.com

Problem	Potential Cause	Solution
Sound is weak	Low battery power	Charge immediately
	Speaker and earbud is clogged	Clear clogs or replace earbud
	The degree of hearing loss is changed	Adjust the volume or ask a doctor for assistance
	Dirt accumulation	Clean the hearing device
Functionality problems	Low battery power	Charge immediately
	Speaker and earbud is clogged	Clear clogs or replace earbud
Sound is not clear, distortion, no sound	Low battery power	Charge immediately
	Speaker and earbud is clogged	Clear clogs or replace earbud
	Hearing device malfunction	Consult the hearing service center

Familiar with Hearing Aid

The average user is expected to take weeks to get completely used to hearing aids. You must practice repeatedly until the brain can adapt to the new sounds provided by hearing aids. Hearing is part of sharing thoughts, plans, and senses. Reading lips, facial expressions, and gestures can help and smoothen the learning process.

- The parts that your family and friends need to be aware of
 1. Ask the user to focus before the conversation.
 2. In a quiet environment, let the user watch himself talk.
 3. Speak clear & gently. Speaking loudly/ too low makes speech comprehension worse.
 4. Avoid repeating the same word when you can't hear clearly, and try other synonyms to increase understanding.

- The section that the user should pay attention to
 1. Approach and watch the speaker with focus.
 2. Choose to talk in a quiet environment and sit face-to-face with the speaker.
 3. Try different locations to find the best listening position.
 4. Background noise may make you feel a little uncomfortable and depressed, but please be patient. Try to listen to information when the background noise is reduced.
 5. Let others know what you need, and note that the average person is "uninformed" about your hearing.
 6. Proper expectations and try to understand the limits of hearing aid capabilities.
 7. Using hearing aids is a learning process that combines longing, repeated practice, and patience.

SPECIFICATION

Max. Output @ SPL 90 dB

135 ± 5 dB @ SPL 90 dB

Max. Gain

60 ± 5 dB

Continuous Use

Up to 10 hours per charge

Listening Mode

3 Modes

Suitable for

People with moderate to severe hearing loss

Storage Temperature:

14°F ~ 140°F

Storage Humidity

30% ~ 85%

Dimension

44 x 20 x 27mm

Weight

22.7g

Place of Origin

Taiwan

